

Bateswood Local Nature Reserve

Proposals for new equestrian route and to allow fishing



OPERATIONAL SERVICES :: LANDSCAPE DEVELOPMENT

Design for Fishing Platform

The design, number required, and locations of proposed fishing platforms is to be drawn up in conjunction with members of local fishing clubs.

A platform is to be constructed to the standards recommended by the British Disabled Angling Association.

The need for additional floating baskets is to be discussed with fishing clubs.

Use of the pool for fishing will be managed by an angling club and subject to a robust agreement with anglers to control issues such as access, fish stocking and marginal habitat management.

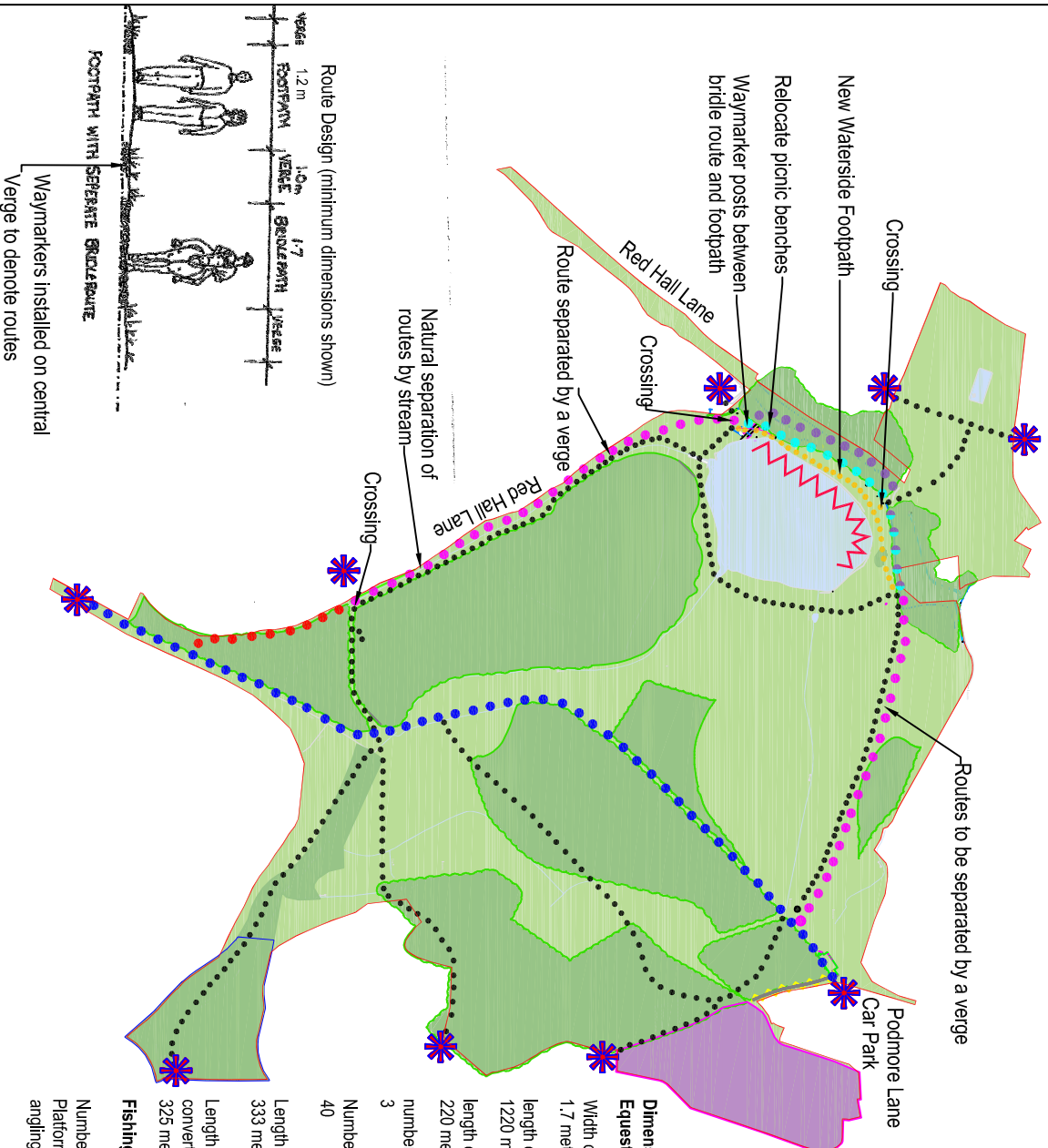

- Dimensions**
- Equestrian Route:**
- Width of new Bridle route 1.7 meters
 - length of new Bridle route 1220 meters
 - length of unsurfaced section 220 meters
 - number of crossing points 3
 - Number of waymarkers 40
 - Length of new section of footpath 333 meters
 - Length of section of footpath to be converted to bridle route 325 meters
- Fishing Platforms:**
- Number, design and location of Platforms to be agreed with local angling clubs.

